

Part number:

**HYDROMA**

HYDRAULICKÉ SYSTÉMY

**HIDROMA  
SISTEMS**

UKŁADY HYDRAULICZNE

**HYDROMA**

ГИДРАВЛИЧЕСКИЕ СИСТЕМЫ

# Flow Monitor Flow Indicator

## DKM/A

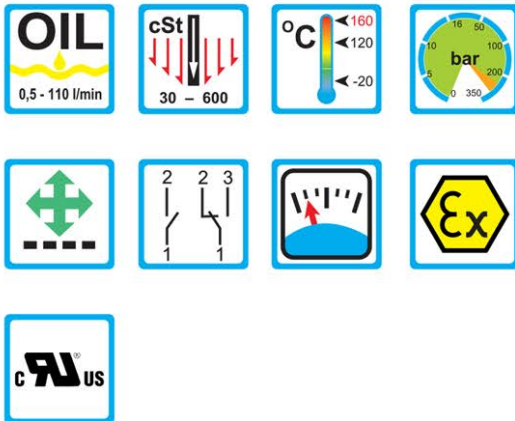

### Areas of Application

#### Method of Operation

- Float measuring principle

#### Areas of Application

- Machine construction
- Central lubrication
- Circulation lubrication
- Transformers

#### Features

- Universal orientation
- High reliability
- Viscosity compensated
- High switch accuracy
- Infinitely variable switchpoint adjusted by user
- EX-version to ATEX available
- Threaded connection, special threads on request
- High pressure resistance

#### Installation information

- The operating instruction for DKM/A must be observed
- Download: [www.meister-flow.com](http://www.meister-flow.com)

### Operating Data

Operating pressure max.	250 bar (MS) / 300 bar (VA)
Pressure drop	0,02 - 0,4 bar
Viscosity range	30 cSt to 600 cSt
Maximum temperature	120 °C (optional 160 °C)
Accuracy	±10 % of full scale

### Measuring Ranges

Type	Switch range for oil, density 0,9 kg/dm <sup>3</sup> <sup>(1)</sup>		
	[l/min]	[gph]	[gpm]
DKM/A-1/2	0,5 - 1,5	8,0 - 24,0	
DKM/A-1/4	1 - 4	16,0 - 63,0	
DKM/A-1/8	2 - 8	32,0 - 127,0	
DKM/A-1/10	3 - 10	48,0 - 160,0	
DKM/A-1/15	5 - 15	80,0 - 240,0	
DKM/A-1/24	8 - 24	125,0 - 380,0	
DKM/A-1/30	10 - 30	160,0 - 480,0	
DKM/A-1/45	15 - 45	240,0 - 710,0	
DKM/A-1/60	20 - 60	320,0 - 950,0	
DKM/A-1/90	30 - 90		8,0 - 24,0
DKM/A-1/110	35 - 110		9,5 - 29,0

<sup>(1)</sup> The specified data are switch-off points, other switch ranges on request.

# Technical Data

## Mechanical drawing

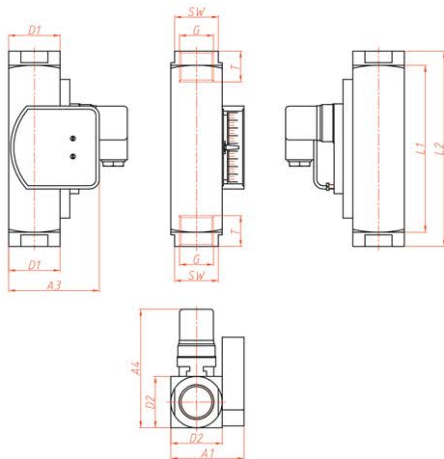

## Connection diagram

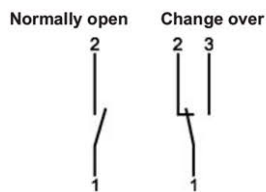

## Summary of types

Type:	Overall dimensions [mm]												Weight approx. [g]
	SW	L1	L2	D1	G	T	D2	DN	A1	A2	A3	A4	
DKM/A-1/2	34		152		1/4"	10		8					
	34	130	152	40	1/2"	14	40 / 40	15	57	-	70,5	approx. 93	1515
	34		152		3/4"	15		20					1430
DKM/A-1/4	40		130		1"	17		25					1250
DKM/A-1/8	34		152		1/2"	14		15					1515
DKM/A-1/10	34	130	152	40	3/4"	15	40 / 40	20	57	-	70,5	approx. 93	1430
DKM/A-1/15	40		130		1"	17		25					1250
DKM/A-1/24	40		130		1"	17		25					1250
DKM/A-1/30	34		152		3/4"	15		20					1430
DKM/A-1/45	40	130	130	40	1"	17	40 / 40	25	57	-	70,5	approx. 93	1250
DKM/A-1/60	40		130		1"	17		25					1250
DKM/A-1/90	40	130	130	40	1"	17	40 / 40	25	57	-	70,5	approx. 93	1250
DKM/A-1/110	40		130		130	1"		17					25

## Material

### Brass version

#### Wetted parts:

Spring: 1.4571  
 Gaskets: FKM  
 (optional NBR, EPDM)<sup>(3)</sup>  
 Magnets: Hard ferrite  
 Housing: Brass nickel-plated

all other wetted parts: Brass

## Electrical Data

**Change over** 250V • 1,5A • 50VA<sup>(2)</sup>

**Normally open** 250V • 3A • 100VA

**ATEX II 2 G Ex mb II T6 & ATEX II 2 D Ex tD A21 IP67 T80 °C**

**ATEX II 2 G Ex mb II T5 & ATEX II 2 D Ex tD A21 IP67 T100 °C**

**Change over** 250V • 1A • 30VA

**Normally open** 250V • 2A • 60VA

**Change over M 12x1 (-20 °C - 85 °C)** 250V • 1,5A • 50VA<sup>(2)</sup>

**Normally open M 12x1 (-20 °C - 85 °C)** 250V • 3A • 100VA

**Change over SPS** 250V • 1A • 60VA

### Ingress Protection:

IP65: plug connection DIN 43650 Form A

IP67: 1 m sealed in cable, (with EEx-version 2 m)

or plug connection M 12x1

### Output signal

The contact opens / changes when the flow decreases below the set point.

### Power supply

Not required (potentialfree reed contacts)

### Plug types

Other plug types or cable lengths on request

<sup>(2)</sup> Minimum load 3 VA